

# Direct Weld Compression Fittings—Technical Guide

*Note: for Reference purposes only*

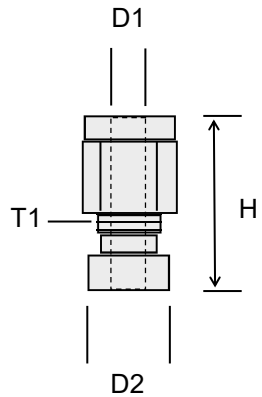

|               | T1      | H             | D1<br>(ID)      | D2<br>(OD)    | For Thermocouple Probe<br>Sheath O.D. |
|---------------|---------|---------------|-----------------|---------------|---------------------------------------|
| CF-0125-DW-SS | 5/16-20 | 0.90" (22 mm) | 0.135" (3.4 mm) | 0.44" (11 mm) | 1/8"                                  |
| CF-0187-DW-SS | 3/8-20  | 0.93" (23 mm) | 0.192" (4.9 mm) | 0.44" (11 mm) | 3/16"                                 |
| CF-0250-DW-SS | 7/16-20 | 0.96" (34 mm) | 0.258" (6.5 mm) | 0.50" (12 mm) | 1/4"                                  |

|                    |                     |
|--------------------|---------------------|
| Material           | 316 Stainless Steel |
| Number of Ferrules | 1 (single type)     |

| Base OD       | Drill         |
|---------------|---------------|
| 0.44" (11 mm) | 7/16 (0.437") |
| 0.50" (12 mm) | 1/2 (0.500")  |

### Tightening the fitting

- For 1/16" to 3/16" outer diameter probes turn 3/4 past finger tight
- For 1/4" outer diameter probes turn 1-1/4 past finger tight
- For reassembly after initial installation turn 1/4 past finger tight

### Order of Assembly:

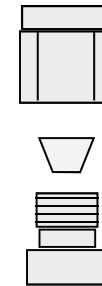

### Installation Guideline:

