

Direct Weld Compression Fittings—Technical Guide

Note: for Reference purposes only

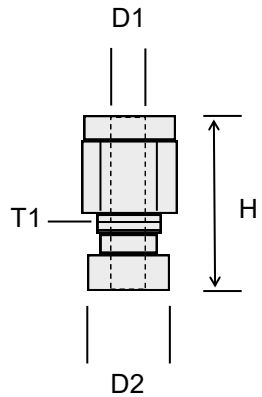

	T1	H	D1 (ID)	D2 (OD)	For Thermocouple Probe Sheath O.D.
CF-0125-DW-SS	5/16-20	0.90" (22 mm)	0.135" (3.4 mm)	0.44" (11 mm)	1/8"
CF-0187-DW-SS	3/8-20	0.93" (23 mm)	0.192" (4.9 mm)	0.44" (11 mm)	3/16"
CF-0250-DW-SS	7/16-20	0.96" (34 mm)	0.258" (6.5 mm)	0.50" (12 mm)	1/4"

Material	316 Stainless Steel
Number of Ferrules	1 (single type)

Base OD	Drill
0.44" (11 mm)	7/16 (0.437")
0.50" (12 mm)	1/2 (0.500")

Order of Assembly:

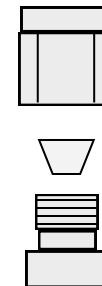

Installation Guideline:

